



eos2015
V E N I C E

91st Congress of the European Orthodontic Society
June 13th-18th / 2015 Venice / Italy

 programme





Meeting Rooms

Palazzo del Cinema:

Main Congress Room

Palazzo del Casinò 1st floor:

Sala Perla,

Sala Casinò,

Sala delle Feste,

3 Sala Welles,

4 Sala Hoffman

Palazzo del Casinò 2nd floor :

Sala Amici,

10 Sala Mangano,

11 Sala Rossi Drago,

13 Sala Chiari,

14 Sala Koscina

15 Sala Buy

Exhibition Rooms

Palazzo del Cinema

Palazzo del Casinò 1st floor:

Atrio

Palazzo del Casinò 3rd floor:

Sala Laguna & Sala Adriatico

Poster Halls

Palazzo del Casinò Ground floor:

Darsena

Palazzo del Casinò 2nd floor:

10 Sala Mangano,

11 Sala Rossi Drago,

12 Sala Martinelli,

15 Sala Buy

16 Sala Rondi

Palazzo del Casinò 3rd floor:

Sala Mosaici 1

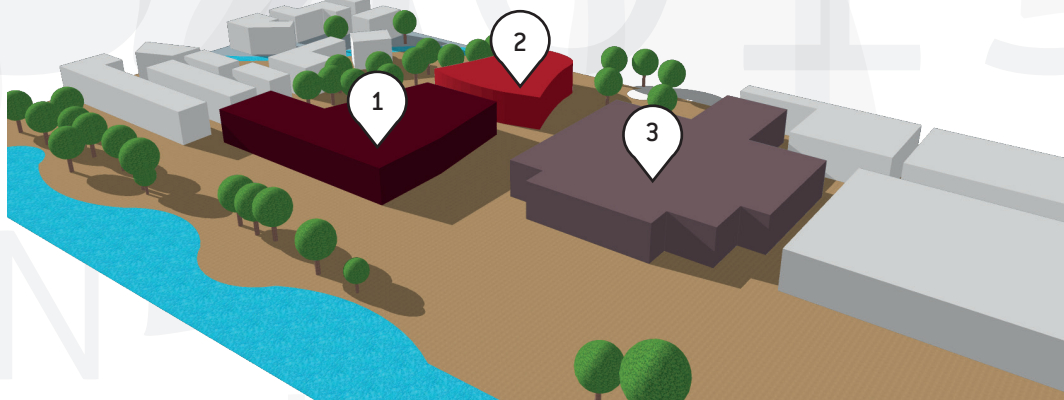

1. Palazzo del Cinema
2. Sala Darsena (Pala Galileo)
3. Palazzo del Casinò

Saturday, June 13th

VENUE

09:00 - 18:00	EBO Examination	Palazzo del Casinò 2 nd floor - Sala Amici, 10 Sala Mangano, 11 Sala Rossi Drago, 13 Sala Chiari, 14 Sala Koscina, 15 Sala Buy
09:00 - 17:00	SIDO Pre-Congress Course	Palazzo del Casinò 1 st floor - Sala Casinò
12:00 - 16:00	EFOSA Council Meeting	Palazzo del Casinò 1 st floor - 3 Sala Welles
14:00 - 18:00	EPSOS Meeting	Palazzo del Casinò 1 st floor - Sala delle Feste

Sunday, June 14th

VENUE

08.30 - 18.00	Registration	Palazzo del Cinema - Hall
08.30 - 16.30	Pre-Congress Course	Palazzo del Casinò 1 st floor - Sala delle Feste
08.30 - 10.00	NEBEOP Meeting	Palazzo del Casinò 1 st floor - Sala Casinò
09.00 - 12.00	EFOSA General Assembly	Palazzo del Casinò 1 st floor - 3 Sala Welles
09.00 - 16.00	Postgraduate Course	Palazzo del Casinò 1 st floor - Sala Perla
09.00 - 18.00	EBO Examination	Palazzo del Casinò 2 nd floor - Sala Amici, 10 Sala Mangano, 11 Sala Rossi Drago, 13 Sala Chiari, 14 Sala Koscina, 15 Sala Buy
10.00 - 14.00	European Orthodontic Teachers' Forum	Palazzo del Casinò 1 st floor - Sala Casinò, 5 Sala Spielberg, 6 Sala Beatty, 7 Sala Kubrik, 9 Sala Pfeiffer
12.00 - 15.00	EOS Opening Council Meeting	Palazzo del Casinò 1 st floor - 4 Sala Hoffman
17.00 - 18.45	Opening Ceremony	Palazzo del Cinema - Main Congress Room, Sala Darsena (Pala Galileo)
19.00 - 21.00	Opening of the Trade Exhibition	Palazzo del Casinò 1 st floor and 3 rd floor

PROGRAMME OUTLINE

Monday June 15th

VENUE

08.30 - 18.00	Registration	Palazzo del Cinema - Hall
08.30 - 18.00	EBO Case Display	Palazzo del Casinò 2 nd floor - Sala Amici
09.00 - 18.00	Trade Exhibition	Palazzo del Casinò 1 st floor and 3 rd floor
09.40 - 10.25	Sheldon Friel Lecture 	Palazzo del Cinema-Main Congress Room, Palazzo del Casinò 1 st floor- Sala Perla
09.00 - 18.00	Scientific Session Houston Research Award Lectures	Palazzo del Cinema - Main Congress Room, Palazzo del Casinò 1 st floor - Sala Perla
12.15 - 13.00	Satellite Symposium sponsored by Opal Orthodontics	Palazzo del Casinò 1 st floor - Sala delle Feste
20.00 - 24.00	President's Reception	Hotel Excelsior - Lido di Venezia

Tuesday June 16th

VENUE

08.30 - 18.00	Registration	Palazzo del Cinema - Hall
09.00 - 18.00	Trade Exhibition	Palazzo del Casinò 1 st floor and 3 rd floor
09.00 - 18.00	Scientific Session	Palazzo del Cinema - Main Congress Room, Palazzo del Casinò 1 st floor - Sala Perla
12.15 - 13.00	Satellite Symposium sponsored by Invisalign	Palazzo del Casinò 1 st floor - Sala delle Feste Palazzo del Casinò Ground Floor - Darsena
16.00 - 18.00	Poster Session	Palazzo del Casinò 2 nd floor: 10 Sala Mangano, 11 Sala Rossi Drago, 12 Sala Martinelli, 15 Sala Buy, 16 Sala Rondi, Palazzo del Casinò 3 rd floor - Sala Mosaici 1
17.15 - 18.00	Satellite Symposium sponsored by Colgate	Palazzo del Casinò 1 st floor - Sala delle Feste
21.00 - 02.00	Postgraduate Disco	Pachuka

ISOLA DI SAN SERVOLO

S. Servolo 20



- 1
- 2
- 3
- 4
- 5
- 6
- N
- LN
- S. Elena
- S. Elena 4.1
- S. Elena 4.2
- S. Elena 5.1
- S. Elena 5.2

Lido Santa Maria Elisabetta



Palazzo del Cinema

Grand Hotel Excelsior

Piazzale Del Casino

Wednesday June 17th

VENUE

08:30 - 18:00	Registration	Palazzo del Cinema - Hall
09:00 - 18:00	Trade Exhibition	Palazzo del Casinò 1 st floor and 3 rd floor
09:00 - 17:00	Scientific Session	Palazzo del Cinema - Main Congress Room Palazzo del Casinò 1 st floor - Sala Perla
12:30 - 13:00	Award Ceremony	Palazzo del Cinema - Main Congress Room Palazzo del Casinò 1 st floor - Sala Perla
13:00 - 14:00	Lunch Time EOS Closing Council Meeting	
17:10	EOS Business Meeting	Palazzo del Cinema - Main Congress Room
20:00 - 23:00	Gala Dinner	Scuola San Giovanni Evangelista

Thursday June 18th

VENUE

09:00 - 14:30	Silver Mill Competition and Outing	
---------------	------------------------------------	--

SCIENTIFIC PROGRAMME

MONDAY
15-06-2015

SCIENTIFIC SESSION I | Session Chairs: Antonio Miotti and Christos Katsaros

9.00 - 9.10	<p>WJB Houston Oral Research Award (H01) IMPACT OF EXTRACORPOREAL SHOCKWAVE THERAPY ON TOOTH MOBILITY IN ADULT ORTHODONTIC PATIENTS: A RANDOMIZED PLACEBO-CONTROLLED CLINICAL TRIAL. Frank Falkensammer¹, Xiaohui Rausch-Fan^{1,2}, Wolfgang Schaden³, Danijel Kivaranovic⁴, Josef Freudenthaler¹, Departments of ¹Orthodontics and ²Oral Biology, University Clinic of Dentistry Vienna³, Department of Traumatology, AUVA Trauma Center and Ludwig Boltzmann Institute for Experimental and Clinical Traumatology, Vienna and ⁴Department of Medical Statistics, Medical University of Vienna, Austria.</p>
9.10 - 9.20	<p>WJB Houston Oral Research Award (H02) GENETIC ASSOCIATION OF ARHGAP21 GENE VARIANT WITH MANDIBULAR PROGNATHISM. Maddalena Vitale¹, Letizia Perillo¹, Angela Monsurrò¹, Annalaura Torella², Vincenzo Nigro², Departments of ¹Orthodontics and ²Biochemistry, Biophysics and General Pathology, Second University of Naples, Italy.</p>
9.20 - 9.30	<p>WJB Houston Oral Research Award (H03) A THREE-DIMENSIONAL POPULATION-BASED HERITABILITY STUDY OF FACIAL MORPHOLOGICAL TRAITS IN UK FEMALE TWINS. Jelena Djordjevic, Alexei Zhurov, Stephen Richmond, Department of Applied Clinical Research and Public Health, Cardiff University, U.K.</p>
9.30 - 9.40	QUESTIONS
9.40 - 10.25	<p>Sheldon Friel Lecture: THE DENTOALVEOLAR PROCESS: DO WE KNOW THE PLAYING FIELD WE WORK IN? Stavros Kiliaridis, Department of Orthodontics, Dental School - Faculty of Medicine, University of Geneva, Switzerland</p>
10.25 - 10.55	COFFEE BREAK

SCIENTIFIC SESSION II | Session Chairs: Rosalisa Leonardi and Paul-Georg Jost-Brinkmann

10.55 - 11.25	<p>KL1: EARLY OR LATE TREATMENT IN ORTHODONTICS. Lorenzo Franchi, Italy.</p>
11.25 - 11.55	<p>KL2: EARLY OR LATE TREATMENT IN ORTHODONTICS POSTERIOR OR ANTERIOR CROSSBITE – IS EARLY TREATMENT EFFECTIVE AND STABLE IN THE LONG-TERM? Lars Bondemark, Sweden.</p>
11.55 - 12.05	<p>OP1: TREATMENT OF MAXILLARY RETROGNATHISM WITH MAXILLARY TRACTION: FACE MASK COMPARED WITH TRACTION ON BONE ANCHORS. Miha Bobic¹, Paolo Cattaneo¹, Jytte Buhl², Thomas Klit Pedersen¹, ¹Section of Orthodontics, Aarhus University and ²Department of Maxillofacial Surgery, Aarhus University Hospital, Denmark.</p>
12.05 - 12.15	<p>OP2: DETERMINATION OF AGE AT PUBERTAL ONSET BASED ON ANNUAL HEIGHT MEASUREMENTS. Johan Karlberg¹, Urban Hagg², ¹Clinical Trial Magnifier Ltd, Hong Kong and ²Department of Dentistry, University of Hong Kong, China.</p>
12.15 - 12.25	<p>OP3: EARLY ORTHODONTIC AND SURGICAL TREATMENT IN PATIENTS WITH HEMIFACIAL MICROSOMIA (GOLDENHAR SYNDROME): PROCEDURES AND TIMING. Noah Cohen¹, Erica Cohen¹, Joseph Felix Giordanetto¹, Jacque-Marie Mercier², Amnon Cohen¹, ¹Department of Pediatrics, Inter-Regional Center for Rare Diseases, San Paolo Hospital, Savona, Italy and ²Service de chirurgie maxillo- faciale et stomatologie - chirurgie plastique pédiatrique, CHU de Nantes, France.</p>
12.25 - 12.35	<p>OP4: EVALUATION OF TREATMENT EFFECTS AFTER BONE ANCHORED MAXILLARY PROTRACTION IN GROWING CLASS III PATIENTS – A CONE BEAM COMPUTED TOMOGRAPHY STUDY. Neel de Vos Rijs¹, Paolo Cattaneo¹, Jytte Buhl², Thomas Klit Pedersen¹, ¹Orthodontic Section, Aarhus University and ²Department of Maxillofacial Surgery, Aarhus University Hospital, Denmark.</p>
12.35 - 12.45	<p>OP5: FACIAL ASYMMETRY IN UNILATERAL POSTERIOR CROSSBITE AFTER PALATAL EXPANSION IN THE PRIMARY AND EARLY MIXED DENTITION PHASES. IS THERE A DIFFERENCE? Jasmina Primozic¹, Vinka Rajkovic², Stephen Richmond³, Alexei Zhurov³, Maja Ovsenik¹ ¹University of Ljubljana, ²Orthos, Institute of orthodontics and maxillofacial othopaedics, Ljubljana, Slovenia and ³University of Cardiff, U.K.</p>

SCIENTIFIC PROGRAMME

12.45 - 12.55	OP6: IS ORTHODONTICS PRIOR TO 11 YEARS OF AGE EVIDENCE-BASED? A SYSTEMATIC REVIEW AND META-ANALYSIS. Radha Sunnak, Ama Johal, Padhraig Fleming, Department of Orthodontics, Queen Mary University of London, U.K.
12.55 - 13.05	DISCUSSION
13.05 - 14.00	LUNCH BREAK

SCIENTIFIC SESSION III | Session Chairs: Maria Piacino and Letizia Perillo

14.00 - 14.30	 OP5: INTEGRATED ORTHODONTIC CARE THE 4TH DIMENSION OF TIME AND ITS IMPORTANCE IN MULTI-DISCIPLINARY TREATMENT - HOW THE DENTAL TEAM ENHANCES FACIAL AND DENTAL AESTHETICS FOR A LIFE TIME. David Sarver, USA.
14.30 - 14.40	OP7: ORTHODONTIC TOOTH MOVEMENTS AND REGENERATIVE PERIODONTAL PROCEDURES IN THE TREATMENT OF SEVERE INTRABONY DEFECTS. Christina Tietmann ¹ , Peter Wuellenweber ² , Frank Broeseler ¹ , Tamar Axelrad ³ , Soeren Jepsen ³ , ¹ Zahnärztliche Praxis für Parodontologie, Aachen, ² Kieferorthopädische Praxis, Aachen and ³ Department of Periodontology, Operative and Preventive Dentistry, University of Bonn, Germany.
14.40 - 14.50	OP8: AESTHETIC OUTCOME OF AUTOTRANSPLANTED PREMOLARS REPLACING MAXILLARY INCISORS: A RETROSPECTIVE STUDY. Stephanie Tourne ¹ , Stani Politis ² , Dick Barendregt ³ , Guy De Pauw ¹ , Pawel Plakwicz ⁴ , ¹ Department of Orthodontics, University of Ghent, Belgium, ² Hospital ZOL, Genk, Belgium, ³ Practice ParoRotterdam, Rotterdam, Netherlands and ⁴ University of Warsaw, Poland.
15.00 - 15.10	OP10: THREE-DIMENSIONAL ANALYSIS OF SOFT TISSUE CHANGES FOLLOWING ORTHOGNATHIC SURGERY IN SKELETAL CLASS III PATIENTS. Natasa Ihan Hren, Miha Verdenik Clinical Department of Maxillofacial and Oral Surgery, Medical Faculty, Ljubljana, Slovenia.

CONTINUES ->

15.10-15.20	<p>OP11: THE IMPACT OF HYPODONTIA ON ORAL HEALTH-RELATED QUALITY OF LIFE IN CHILDREN. <i>Azza Al-Ani, Joseph Antoun, Cindy Mullens, Mauro Farella, University of Otago, Dunedin (New Zealand)</i></p>
15.20-15.30	<p>OP12: PURE BONE BORNE MAXILLARY EXPANSION WITH FOUR MINI-IMPLANTS IN ADULTS WITH AND WITHOUT SURGICAL ASSISTED RAPID PALATAL EXPANSION: A CONSECUTIVE STUDY OF 35 PATIENTS*** <i>Heinz Winsauer¹, Alfred Peter Muchitsch², Clemens Winsauer³, Doreen Jaeschke⁴, Andre Walter⁵, Dental University of Graz, ¹Bregenz and ²Graz, Austria, ³Orthodontic center Bregenz, Austria, ⁴Dental University Marburg, Germany and ⁵Universidad Internacional de Catalunya, Barcelona, Spain.</i></p>
15.30 - 15.40	DISCUSSION
15.40 - 16.00	COFFEE BREAK

SCIENTIFIC SESSION IV | Session Chairs: Paul Démogé and Ambra Michelotti



16.00 - 16.30	<p> INTEGRATED ORTHODONTIC CARE AND FREE TOPICS. SCIENTIFIC BASIS OF THE CHANGE IN FACIAL MORPHOLOGY. CLINICAL CONSEQUENCES. <i>Giuseppe Ferronato, Italy.</i></p>
16.30 - 16.40	<p>OP13: PERCEIVED ATTRACTIVENESS ON FRONTAL AND LATERAL PHOTOGRAPHS. <i>Cristina De la Cruz Martínez, Juan Sánchez Holgado, Joaquín Sanz Coarasa, Jorge Longar González, Javier De la Cruz Pérez, Department of Dentistry, University Alfonso X El Sabio, Villanueva de la Cañada, Madrid, Spain.</i></p>
16.40 - 16.50	<p>OP14: IMPACT OF SELF-ESTEEM AND PERSONALITY TRAITS ON THE ASSOCIATION BETWEEN ORTHODONTIC TREATMENT NEED AND ORAL HEALTH-RELATED QUALITY OF LIFE IN ADULTS SEEKING ORTHODONTIC TREATMENT. <i>Maité Clijmans¹, Jurgen Lemiere², Steffen Fieuws³, Guy Willems¹, Department of Oral Health Sciences - Orthodontics, KULeuven, ²Child and Adolescent Psychiatry/Pediatric Haemato-Oncology, KU Leuven, UZ Gasthuisberg, ³Interuniversity Institute for Biostatistics and Statistical Bioinformatics, KU Leuven and Universiteit Hasselt, Leuven, Belgium.</i></p>
16.50 - 17.00	<p>OP15: CHANGES OF ORAL HEALTH RELATED QUALITY OF LIFE DURING AND AFTER ORTHODONTIC TREATMENT. <i>Fahimeh Farzanegan¹, Farzin Heravi¹, Elham Noori², ¹Department of Orthodontics, Mashhad University of Medical Sciences and ²Private practice, Mashhad, Iran.</i></p>

SCIENTIFIC PROGRAMME

17.00 - 17.10	<p>OP16: IMPACT OF SOCIOECONOMIC FACTORS ON ORAL HEALTH-RELATED QUALITY OF LIFE IN A COHORT OF ORTHODONTIC PATIENTS.</p> <p>Grace Nichols¹, Joseph Antoun¹, Peter Fowler², Azza Al-Ani¹, Mauro Farella¹, ¹Department of Oral Sciences, University of Otago, Dunedin and ²Christchurch Hospital, New Zealand.</p>
17.10 - 17.20	<p>OP17: COMPARISON OF IBUPROFEN WITH CHEWING GUM ON PAIN REDUCTION AFTER INITIAL ARCHWIRE PLACEMENT IN ORTHODONTIC PATIENTS.</p> <p>Faizan Ali, Javeria Asif Cheema, Rabia Aziz, Department of Orthodontics, Children Hospital & Institute of Child Health, Lahore, Pakistan.</p>
17.20 - 17.30	<p>OP18: HERBST APPLIANCE TREATMENT - LINGUAL VERSUS LABIAL: DOES IT MAKE A DIFFERENCE?</p> <p>Niko Bock¹, Sabine Ruf¹, Theresa Jilek², ¹Department of Orthodontics, University of Giessen and ²Private Practice, Bad Essen, Germany</p>
17.30 - 17.40	<p>OP19: COMPARISON OF ORTHODONTIC TREATMENT DURATION AND PEER ASSESSMENT INDEX SCORES OF CLASS II PATIENTS.</p> <p>Eleni Malamou, Derya Cakan-Germec, Feyza Ulkur, Department of Orthodontics, Yeditepe University, Dental Faculty, Istanbul, Turkey.</p>
17.40 - 17.50	<p>OP20: CLINICAL OUTCOMES OF DIFFERENT CLASS II TREATMENT MODALITIES USING THE AMERICAN BOARD OF ORTHODONTICS OBJECTIVE GRADING SYSTEM.</p> <p>Hatice Akinci Cansunar¹, Tancan Uysal², ¹Inonu University, Malatya and ²Izmir Katip Celebi University, Izmir, Turkey.</p>
17.50 - 18.00	DISCUSSION

TUESDAY
16-06-2015

SCIENTIFIC SESSION V | Session Chairs: Maja Ovsenik and Demetrios Halazonetis

9.00 - 9.30	 5: SCIENTIFIC BASED CLINICAL DECISIONS. FUNCTIONAL APPLIANCES AND THE FACE. Andrew DiBiase, U.K.
9.30 - 9.40	OP21: THE QUALITY OF THE EVIDENCE ACCORDING TO GRADE IS PREDOMINANTLY LOW OR VERY LOW IN ORAL HEALTH SYSTEMATIC REVIEWS. Nikolaos Pandis ¹ , Padhraig Fleming ² , Helen Worthington ³ , Georgia Salanti ⁴ , ¹ University of Bern, Switzerland, ² Queen Mary University of London, U.K., ³ University of Manchester, U.K. and ⁴ University of Ioannina, Greece.
9.40 - 9.50	OP22: WHICH WHITE WIRE? A MULTI-CENTRE RANDOMISED CONTROLLED TRIAL ON ALIGNMENT EFFICIENCY AND COLOUR PERFORMANCE. Zaid Esmail, Aman Ulhaq, Anis Kamaruddin, Dirk Bister, Martyn Sherriff, Department of Orthodontics, King's College London U.K.
9.50 - 10.00	OP23: A NOVEL PANEL OF SPECIFIC PROTEIN BIOMARKERS FOR ROOT RESORPTION ASSOCIATED WITH ORTHODONTIC TOOTH MOVEMENT FOR USE IN EVERYDAY CLINICAL PRACTICE TOOTH MOVEMENT FOR USE IN EVERYDAY CLINICAL PRACTICE.  Karolina Kaczor-Urbanowicz, Omer G. Tsch Aaron Palmon, Stella Chaushu, Institute of Dental Sciences, The Hebrew University- Hadassah Dental School of Medicine, Jerusalem, Israel
10.00 -10.10	OP24: COMBINED ORTHODONTIC AND ORTHOGNATHIC SURGICAL TREATMENT IN PATIENTS OVER 40 YEARS OF AGE. Thomas Präger ¹ , Max Zinser ² , Joachim Zöllner ² , Robert Mischkowski ² , ¹ Department of Orthodontics, Dento-facial Orthopedics and Pedodontics, Charité - Universitätsmedizin Berlin and ² Department of Oral and Maxillofacial Surgery, University Hospital Cologne, Germany.
10.10 -10.20	OP25: DENTAL CALCIFICATION STAGES AS DETERMINANTS OF THE PEAK GROWTH PERIOD. George Litsas ¹ , Athanasios Athanasiou ² , Ioulia Ioannidou-Marathiotou ³ , ¹ Practice, Kozani, Greece, ² Dubai College of Dental Medicine, Dubai, United Arab Emirates and ³ Department of Orthodontics, Aristotle University of Thessaloniki, Greece.
10.20 - 10.30	DISCUSSION
10.30 - 11.00	COFFEE BREAK

SCIENTIFIC PROGRAMME

SCIENTIFIC SESSION VI | Session Chairs: Thomas Klit Pedersen and Paola Cozza

11.00 - 11.30	 OP25: IS THERE STILL A NEED FOR EXTRACTIONS? EXTRACTION VERSUS NON-EXTRACTION: STILL HAVE UBTBS? Giuliano Maino, Italy.
11.30 - 11.40	OP26: ORTHODONTICALLY INDUCED EXTRACTION IN GERMANY - A SURVEY ON PREVALENCE, LOCALISATION AND INDICATION. <u>Susanne Wriedt</u> , Alessja Indin-Wolf, Heinrich Wehrbein, Department of Orthodontics, J.-Gutenberg University Medical Center, Mainz, Germany.
11.40 - 11.50	OP27: THE EFFECTS OF ORTHODONTIC TREATMENT WITH EXTRACTIONS ON THE SKELETAL VERTICAL DIMENSION. A SYSTEMATIC REVIEW. <u>Georgios Kouvelis</u> ¹ , Konstantinos Dritsas ¹ , Ioannis Doulis ¹ , Dimitrios Kloukos ² , Theodore Eliades ³ ¹ Department of Orthodontics and Dentofacial Orthopedics, 251 Hellenic Air Force V.A. General Hospital, Athens, Greece and Departments of Orthodontics and Paediatric Dentistry, ² University of Zurich and ³ University of Bern, Switzerland.
11.50 - 12.00	OP28: THE EFFECT OF PREMOLAR EXTRACTION ON THE POSITION OF LOWER THIRD MOLARS AND THEIR RELATION TO THE ALVEOLAR NERVE: A LONGITUDINAL STUDY. <u>Annelie Miclotte</u> ¹ , Jeroen Van Hevele ² , Reinhilde Jacobs ³ , Constantinus Politis ² , Guy Willems ¹ , ¹ Department of Oral Health Sciences-Orthodontics, KU Leuven & Dentistry UZ Leuven, and KULEuven, ² OMFS IMPATH, Department of Imaging & Pathology, Faculty of Medicine, University Leuven & Maxillofacial Surgery, University Hospitals, Leuven and KULEuven, ³ OIC, OMFS IMPATH Research Group, Department Imaging and Pathology, Faculty of Medicine, University of Leuven and Oral and Maxillofacial Surgery, University Hospitals Leuven and KULEuven, Belgium.
12.00 - 12.10	OP29: THE DECISION TO EXTRACT PREMOLARS: ITS LONG-TERM EFFECT ON GINGIVAL RECESSIONS IN THE LOWER ANTERIOR DENTITION. <u>Raphael Patcas</u> , Nicolas Villard, Clinic for Orthodontics and Pediatric Dentistry, University of Zurich Switzerland.

CONTINUES ->

12.10 - 12.20	<p>OP30: LONG-TERM EVALUATION OF CLASS II SUBDIVISION TREATMENT WITH UNILATERAL MAXILLARY FIRST MOLAR EXTRACTION.</p> <p><u>Christos Livas</u>¹, Nikolaos Pandis², Johan Willem Booij³, Christos Katsaros², Yijin Ren¹, ¹University of Groningen, University Medical Centre Groningen, Netherlands, ²University of Bern, Switzerland and ³Private practice, Gorinchem, Netherlands.</p>
12.20 - 12.30	<p>OP31: THREE-DIMENSIONAL EVALUATION OF LONG-TERM DENTAL ARCH CHANGES WITH AND WITHOUT PREMOLAR EXTRACTIONS.</p> <p><u>Sercan Akyalcin</u>¹, Josh Knowles¹, Jeryl English¹, Moody Alexander², Wick Alexander², ¹Department of Orthodontics, University of Texas Health Science Center, Houston and ²Private Practice, Arlington [USA]</p>
12.30 - 12.40	<p>OP32: LONG-TERM CHANGES IN THE TRANSVERSE DIMENSION OF THE SMILE IN EXTRACTION AND NON-EXTRACTION PATIENTS.</p> <p><u>Sercan Akyalcin</u>¹, Jeryl English¹, Kenner Misner¹, Moody Alexander², Wick Alexander² ¹Department of Orthodontics, University of Texas Health Science Center, Houston and ²Private Practice, Arlington, USA.</p>
12.40 - 12.50	<p>OP33: DO EXTRACTION CASES ACHIEVE BETTER TREATMENT RESULTS?</p> <p><u>Dimitrios Konstantonis</u>, Chrysi Anthonpoulou, Margarita Makou, Department of Orthodontics, University of Athens, School of Dentistry, Greece.</p>
12.50 - 13.00	<p>DISCUSSION</p>
13.00 - 14.00	<p>LUNCH BREAK</p>
13.00 - 13.45	<p>EUROPEAN JOURNAL OF ORTHODONTICS: OPEN SESSION - A QUICK FIRE DEBATE - SYSTEMATIC REVIEWS: SYSTEMATICALLY TELL US WHAT WE ALREADY KNOW.</p> <p>Yijin Ren University of Groningen, EJO Editorial board member, Dirk Bister University of London, EJO associate editor, EOS president 2018. The aim of the session is to highlight the merits of SRs and also stress to some of the pitfalls to avoid when collecting and reporting a SR. We will have a concise fun and educational session. Welcome to all EOS delegates.</p>

SCIENTIFIC PROGRAMME

SCIENTIFIC SESSION VII | Session Chairs: Julian O'Neill and Adriano Crismani

14.00 - 14.30	<p>KEYNOTE TOPICS, SKELETAL ANCHORAGE IN PATIENTS OF DIFFERENT AGES: A JOURNEY FROM ORTHOPAEDICS TO ORTHODONTICS*** Benedict Wilmes, Germany</p>
14.30 - 14.40	<p>OP34: BMP-2 FUNCTIONALIZATION OF MINISCREWS INCREASES STABILITY AND CORTICAL LEVEL BONE-TO-IMPLANT CONTACT – A HISTOMORPHOMETRIC AND MICROCOMPUTED TOMOGRAPHIC EVALUATION. Michael Bertl¹, Adriano Crismani², Michael Rasse³, Volker Kuhn⁴, Rainer Biedermann², ¹University Clinic of Dentistry, Division of Orthodontics, Medical University of Vienna, and Departments of ²Orthodontics, ³Oral and Maxillofacial Surgery and ⁴Trauma Surgery, Medical University of Innsbruck, Austria.</p>
14.40 - 14.50	<p>OP35: SKELETAL AND DENTAL CHANGES IN BONE- AND TOOTH- ANCHORED RAPID MAXILLARY EXPANSION. Manuel Lagraverè¹, Joshua Luebbert¹, Winfried Harzer², ¹University of Alberta, Edmonton, Canada and ²University of Dresden, Germany.</p>
14.50 - 15.00	<p>OP36: EVALUATION OF THE EFFECTS OF BONE ANCHORED MAXILLARY PROTRACTION WITH OR WITHOUT ALTERNATE RAPID EXPANSION AND CONSTRICTION IN THE PEAK PUBERTAL PERIOD Berna Ertekin¹, Elçin Esenlik¹, Yavuz Findik², Hikmet Orhan³, ¹Orthodontic Department, ²Oral and Maxillofacial Surgery Department and ³Public Health Department, Suleyman Demirel University, Isparta, Turkey.</p>
15.00 - 15.10	<p>OP37: XCL11 OVEREXPRESSION IN THE DISINTEGRATING MIDLINE EPITHELIAL SEAM DURING PALATAL FUSION. Maarten Suttorp, Frank Wagener, Anne Marie Kuijpers-Jagtman, Department of Orthodontics and Craniofacial Biology, Radboud University Medical Centre, Nijmegen, Netherlands.</p>

CONTINUES ->

15.10 - 15.20	<p>OP38: EVALUATION OF SECONDARY ALVEOLAR BONE GRAFTED PATIENTS BORN WITH A CLEFT LIP AND PALATE – A LONG-TERM FOLLOW-UP STUDY.</p> <p>Mathias Lemberger^{1,2}, Hedieh Setayesh², Petra Peterson³, Anna Andlin-Sobocki⁴, Agneta Karsten^{1,2}, ¹Department of Orthodontics, ²Karolinska Institutet, Stockholm, ³Department of Plastic and Reconstructive Surgery, Karolinska University Hospital, Stockholm and ⁴Emeritus, Stockholm, Sweden.</p>
15.20 - 15.30	<p>OP39: ORAL CLEFTS AND WOUND HEALING: THE ROLE OF FIBRONECTIN IN MYOFIBROBLAST DIFFERENTIATION.</p> <p>Joël Beyeler, Christos Katsaros, Matthias Chiquet, Department of Orthodontics and Dentofacial Orthopedics, University of Bern, Switzerland.</p>
15.30 - 15.40	<p>OP40: BEYOND ORTHODONTICS: OPPORTUNISTIC PATHOGENS ASSOCIATED WITH ORTHODONTIC RETAINERS.</p> <p>Dheaa Al-Groosh¹, Jonathan Pratten², Nigel Hunt², ¹College of Dentistry / University of Baghdad, Iraq and ²UCL Eastman Dental Institute, London, U.K..</p>
15.40 - 15.50	<p>DISCUSSION</p>
16.00 - 18.00	<p>COFFEE AND POSTER SESSION</p>

**WEDNESDAY
17-06-2015**

SCIENTIFIC SESSION VIII | Session Chairs: Jan Huggare and Selma Elekdag Turk

9.00 - 9.30	<p> FREE TOPICS</p> <p>ANCE BASED ORTHODONTICS AND ITS IMPLICATIONS IN CONTEMPORARY CLINICAL PRACTICE</p> <p>Moschos Papadopoulos, Greece.</p>
9.30 - 9.40	<p>OP41: SATELLITE CELLS FROM HEAD MUSCLES FORM FUNCTIONAL MYOFIBERS IN VITRO</p> <p>Paola Carvajal Monroy, Frank Wagener, Hans Von den Hoff, Department of Orthodontics and Craniofacial Biology, Radboud university medical center, Nijmegen, Netherlands.</p>

SCIENTIFIC PROGRAMME

9.40 - 9.50	OP42: POST-EMERGENT TOOTH ERUPTION OF UNOPPOSED MOLARS IN YOUNG AND ADULT RATS. A COMPARATIVE GENE EXPRESSION ANALYSIS Domna Dorotheou, Thanos Halazonetis, Vanessa Farsadaki, Marie-Luce Piallat-Bochaton, Stavros Kiliaridis, University of Geneva, Switzerland.
9.50 - 10.00	OP43: NATURAL KILLER CELLS PARTICIPATE IN ORTHODONTIC TOOTH MOVEMENT. Omer Fleissig, Ariella Glassner, Jonathan Enk, Ofer Mandelboim, Stella Chaushu, Hebrew University, Jerusalem, Israel.
10.00 - 10.10	OP44: THE LONG-TERM SKELETO-DENTAL EFFECTS OF INTRUSION OF THE MAXILLARY POSTERIOR TEETH IN OPEN BITE PATIENTS. Oyku Dalci ¹ , Riaan Foot ¹ , Ayse Bilgin ² , Nour Eldin Tarraf ¹ , M Ali Darendeliler ¹ , ¹ Department of Orthodontics, University of Sydney and ² Department of Statistics, Macquarie University, Sydney, Australia.
10.10 - 10.20	DISCUSSION
10.20 - 11.00	COFFEE BREAK

SCIENTIFIC SESSION IX | Session Chairs: Pertti Pirttiniemi and Giampietro Farronato

11.00 - 11.30	 9: INTEGRATED ORTHODONTIC CARE AND FREE TOPICS ORTHODONTIC TREATMENT SUCCESSFUL IN PATIENTS WITH PERIODONTITIS? Ewa Czochrowska, Poland.
11.30 - 11.50	AWARD CEREMONY
11.50 - 12.00	Beni Solow Award presentation: TOOTH AGENESIS PATTERNS AND PHENOTYPE VARIATION IN A COHORT OF BELGIAN PATIENTS WITH HYPODONTIA AND OLIGODONTIA CLUSTERED IN 79 FAMILIES WITH THEIR PEDIGREES. Karoline Dreesen, Steven Swinnen, Koenraad Devriendt, <u>Carine Carels</u> , Katholieke Universiteit Leuven, Belgium and Radboud University Nijmegen Medical Centre, Netherlands.
12.00 - 12.10	EOS CONGRESS 2016 - PRESIDENT: JAN HUGGARE

CONTINUES ->

12.10 - 12.20	<p>OP45: POST-TREATMENT CHANGES DURING PERMANENT RETENTION. ARE RETAINERS RELIABLE? <u>Michael P Wolf</u>¹, Ulrike Schulte¹, Katharina Küpper¹, Ludgar Keilig², Andreas Jäger¹, ¹Department of Orthodontics and ²Oral Technology, University of Bonn, Germany.</p> 
12.20 - 12.30	<p>OP46: DO PATIENTS WITH DIFFERENT CRANIOFACIAL PATTERNS GROW DIFFERENTLY? <u>Alexios Katsadouris</u>, Demetrios Halazonetis, Department of Orthodontics, National and Kapodistrian University of Athens, Greece.</p>
12.30 - 12.40	<p>OP47: CLINICAL IMPLICATIONS OF THE DISSIMILARITY BETWEEN MANDIBULAR GROWTH PATTERN AND STATUREL GROWTH PATTERN. <u>Raphael Patcas</u>¹, Timo Peltomäki², <u>Goran Markic</u>¹, ¹Department for Orthodontics and Pediatric Dentistry, Center of Dental Medicine, University of Zurich, Switzerland and ²Oral and Maxillofacial Unit, Department of Ear and Oral Diseases and Department of Otolaryngology, Tampere University Hospital and University of Tampere, Finland.</p>
12.40 - 12.50	<p>OP48: MAXILLARY MOLAR DISTALIZATION IN NON-GROWING PATIENTS WITH CLEAR ALIGNERS: A RETROSPECTIVE CASE-CONTROL STUDY. <u>Gabriele Rossini</u>, Tommaso Castroflorio, Andrea Bargellini, Andrea Deregibus, Cesare Debernardi, Specialization School of Orthodontics, University of Turin - CIR Dental School, Italy.</p>
12.50 - 13.00	DISCUSSION
13.00 - 14.00	LUNCH BREAK
13.00 - 14.00	EOS CLOSING COUNCIL MEETING

SCIENTIFIC SESSION X | Session Chairs: Inger Kjær and Thomas Präger

14.00 - 14.30	<p> INTEGRATED ORTHODONTIC CARE AND FREE TOPICS VIBRATIONAL FORCE AS AN ADJUNCT TO ORTHODONTIC TOOTH MOVEMENT. <u>Martyn Cobourne</u>, United Kingdom.</p>
---------------	---

14.30 - 14.40	<p>OP49: 34 YEARS OF AUTOTRANSPLANTATION - SUCCESS AND FAILURES. <u>Stefan Abela</u>¹, Linda Murtadha², Dirk Bister¹, Jerry Kwok³, Departments of ¹Orthodontics, ²Oral Health and ³Oral Surgery, Guy's and St Thomas' NHS Foundation Trust, London, U.K.</p>
14.40 - 14.50	<p>OP50: COMPARISON OF TWIN BLOCK VERSUS FORSUS APPLIANCE: A CONTROLLED STUDY. <u>Andrea Vangelisti</u>, Veronica Giuntini, Caterina Masucci, Nicolò Defraia, Lorenzo Franchi, Department of Surgery and Translational Medicine, University of Florence, Italy.</p>
14.50 - 15.00	<p>OP51: EVALUATION OF THE LONG-TERM RESULTS OF FACEMASK THERAPY IN CLASS III PATIENTS. <u>Servet Dogan</u>, Orthodontic Department, Ege University School of Dentistry, Izmir, Turkey.</p>
15.00 - 15.10	<p>OP52: EVALUATION OF A THREE-DIMENSIONAL SUPERIMPOSITION TECHNIQUE ON DIFFERENT SKELETAL STRUCTURES OF THE HEAD USING SURFACE MODELS. <u>Nikolaos Gkantidis</u>¹, Michael Schauseil², Berna Zorkun³, Christos Katsaros¹, Björn Ludwig⁴, ¹Department of Orthodontics and Dentofacial Orthopedics, University of Bern, Switzerland, Departments of Orthodontics, ²University of Marburg, Germany, ³Cumhuriyet University, Sivas, Turkey and ⁴University of Saarland, Homburg/Saar, Germany.</p>
15.10 - 15.20	DISCUSSION
15.20 - 15.50	COFFEE BREAK

SCIENTIFIC SESSION XI: Scientific Based Clinical Decision

Session Chairs: Vaska Vandevska-Radunovic and Lorenzo Franchi

15.50 - 16.20	<p>KL11: SCIENTIFICALLY BASED CLINICAL DECISIONS IN ORTHODONTIC TREATMENT FOR IMPACTED TEETH. Stella Chaushu, Israel.</p>
---------------	---

16.20 - 16.30	OP53: DEBONDING OF POLYCRYSTALLINE CERAMIC BRACKETS WITH A ER,CR:YSGG LASER: A NOVEL TECHNIQUE <u>Collin Jacobs</u> ¹ , Ambili Mundethu ¹ , Rene Franzen ² , Norbert Gutknecht ³ , Heiner Wehrbein ¹ , ¹ Department of Orthodontics, University of Mainz, ² AALZ and ³ Department of Restorative Dentistry, University of Aachen, Germany.
16.30 - 16.40	OP54: THERAPEUTIC EFFECTS OF HIGH-FREQUENCY ACCELERATIONS ON ALVEOLAR BONE DENSITY IN OSTEOPOROTIC RATS. <u>Joo Young Nho</u> , Kendrick Park, Dayoon Lee, Tatiana Hladkaya, Department of Dentistry, New York University, New York, USA.
16.40 - 16.50	OP55: CYTOKINES AS MARKERS OF OPTIMAL ORTHODONTIC FORCES. <u>Mohammed Aljearah</u> , Lee Yoobin, Nikhil Narkhede, Cristina Texeira, Consortium for Translational Orthodontic Research, New York University, USA.
16.50 - 17.00	OP56: SHARED GENETIC CONTROL IN THE DEVELOPMENT OF THE PERMANENT DENTITION IN THE MIXED DENTITION STAGE ON DENTAL PANTOMOGRAMS. Kati Kujasalo ¹ , Paula Pesonen ² , <u>Rajja Lähdesmäki</u> ¹ , ¹ Department of Oral Development and Orthodontics, University of Oulu and ² Institute of Dentistry, University of Oulu, Finland.
17.00 - 17.10	DISCUSSION
17.10	EOS BUSINESS MEETING

SATELLITE SYMPOSIA

Monday 15th June 2015 12:15-13:00

Sponsored by: Opal Orthodontics

“McLaughlin - Bennett System 4.0, The Evolution of the Appliance”

Jack Phillips - “Finishing Without Decalcification”

Jan W.A. Doorschodt

Venue: Palazzo del Casinò 1st floor - Sala delle Feste

Tuesday 16th June 2015 12:15-13:00

Sponsored by: Invisalign

“Invisalign technique for complete bio-digital orthodontic treatment: the future is now”

Dr. Alessandro Mario Greco

Venue: Palazzo del Casinò 1st floor - Sala delle Feste

Tuesday 16th Time: 17:15-18:00

Sponsored by: Colgate

“Fluorides during orthodontic treatment: Improving delivery and patient adherence”

Philip Benson, Tim Newton

Venue: Palazzo del Casinò 1st floor - Sala delle Feste

	Company	Palace	Exhibition Hall	Stand Number
1	3DMD LTD	Palazzo del Casinò	Sala Adriatico	51
2	3Shape	Palazzo del Casinò	Sala Laguna	19
3	8th IOC LONDON	Palazzo del Casinò	Atrio	10
4	American Association of Orthodontists	Palazzo del Casinò	Atrio	1
5	AENTA GMBH	Palazzo del Casinò	Sala Laguna	32
6	AESTETIKA SRL	Palazzo del Casinò	Sala Laguna	40
7	ANATOMAGE INC.	Palazzo del Casinò	Sala Adriatico	49
8	ARNO FRITZ MONDEAL	Palazzo del Casinò	Sala Laguna	37
9	AudaxCeph.	Palazzo del Casinò	Sala Laguna	34
10	BBW – ECC - LANCER	Palazzo del Casinò	Sala Adriatico	63
11	CREATIVE DENTAL	Palazzo del Casinò	Sala Adriatico	47
12	CURAPROX	Palazzo del Casinò	Sala Laguna	23
13	DANY BMT	Palazzo del Casinò	Sala Laguna	20
14	Dental Monitoring	Palazzo del Casinò	Sala Adriatico	46
15	Dentaurum GmbH & Co. KG	Palazzo del Casinò	Sala Laguna	31
16	DENTSPLY GAC	Palazzo del Casinò	Sala Adriatico	59

SPONSORS AND EXHIBITORS LIST

	COMPANY	PALACE	EXHIBITION HALL	STAND NUMBER
17	Dolphin Imaging & Management Solution	Palazzo del Casinò	Atrio	9
18	Dontic.com	Palazzo del Casinò	Sala Adriatico	50
19	DW Lingual Systems GmbH	Palazzo del Casinò	Atrio	3
20	DYNAFLEX	Palazzo del Casinò	Sala Laguna	38
21	eCligner at Y line AG	Palazzo del Casinò	Sala Laguna	41
22	EDIZIONI MARTINA	Palazzo del Cinema		3
23	EOS CONGRESS 2016	Palazzo del Cinema		5
24	EUROPEAN ORTHODONTIC SOCIETY	Palazzo del Cinema		2
25	FORESTADENT Bernhard Förster GmbH	Palazzo del Casinò	Atrio	14
26	GC ORTHODONTICS Europe GmbH	Palazzo del Casinò	Sala Adriatico	54
27	Hangzhou Yahong Medical Apparatus Co., Ltd	Palazzo del Casinò	Sala Laguna	43
28	HIGHLAND METALS INC.	Palazzo del Casinò	Sala Adriatico	48
29	HT Co., Ltd	Palazzo del Casinò	Sala Laguna	45
30	Hu-Friedy Mfg. Co. LLC.	Palazzo del Casinò	Sala Adriatico	57
31	Innovative Material and Device, Inc	Palazzo del Casinò	Sala Laguna	17

COMPANY	PALACE	EXHIBITION HALL	STAND NUMBER
32 INVISALIGN	Palazzo del Casinò	Sala Adriatico	55
33 LEONE SPA	Palazzo del Casinò	Atrio	5
34 MEDESY	Palazzo del Casinò	Sala Adriatico	52
35 Modern Orthodontics LLC	Palazzo del Casinò	Sala Laguna	39
36 Motion View Software, LLC	Palazzo del Casinò	Sala Laguna	30
37 Myofunctional Research Co.	Palazzo del Casinò	Atrio	4
38 New York University College of Dentistry - Department of Orthodontics	Palazzo del Cinema		4
39 Opal Orthodontics	Palazzo del Casinò	Atrio	6
40 ORISLINE	Palazzo del Casinò	Sala Laguna	44
41 ORMCO BV	Palazzo del Casinò	Atrio	12
42 Ortho Classic	Palazzo del Casinò	Sala Laguna	36
43 Ortho-Clean International	Palazzo del Casinò	Sala Laguna	18
44 Ortho Technology Inc.	Palazzo del Casinò	Sala Adriatico	60
45 ORTHO-BYTE.COM	Palazzo del Casinò	Sala Laguna	26
46 orthocaps Ortho Caps GmbH	Palazzo del Casinò	Sala Adriatico	56

SPONSORS AND EXHIBITORS LIST

	COMPANY	PALACE	EXHIBITION HALL	STAND NUMBER
47	ORTHODONTICS HARD DISCOUNT	Palazzo del Casinò	Sala Adriatico	61
48	OXFORD UNIVERSITY PRESS	Palazzo del Cinema		1
49	PASTELLI SRL	Palazzo del Casinò	Sala Laguna	21
50	Planmecca Oy	Palazzo del Casinò	Sala Laguna	16
51	Promedia	Palazzo del Casinò	Sala Laguna	29
52	PSM Medical Solutions	Palazzo del Casinò	Sala Adriatico	62
53	PUL Concept	Palazzo del Casinò	Sala Laguna	25
54	PYRAMID ORTHODONTICS INC	Palazzo del Casinò	Sala Laguna	24
55	QUICK CEPH SYSTEMS INC.	Palazzo del Casinò	Sala Adriatico	58
56	Quintessence Publishing	Palazzo del Casinò	Sala Adriatico	53
57	RMO Europe	Palazzo del Casinò	Atrio	7
58	Savaria – Dent KFT	Palazzo del Casinò	Atrio	13
59	SCHEU-DENTAL GmbH	Palazzo del Casinò	Sala Laguna	15
60	Shinye Orthodontics	Palazzo del Casinò	Sala Laguna	33
61	SIDO Italian Society of Orthodontics	Palazzo del Casinò	Atrio	2

COMPANY	PALACE	EXHIBITION HALL	STAND NUMBER
62 SOREDEX	Palazzo del Casinò	Sala Laguna	27
63 SPEED System Orthodontics	Palazzo del Casinò	Atrio	8
64 suresmile	Palazzo del Casinò	Sala Adriatico	54
65 TARGET ORTODONZIA SRL	Palazzo del Casinò	Sala Laguna	35
66 TeleDenta GmbH	Palazzo del Casinò	Sala Laguna	28
67 tops Software	Palazzo del Casinò	Sala Laguna	22

NOTES

Lined area for notes, featuring a large, faint background watermark of the text "EOS 2015".







eos2015
V E N I C E



www.eos2105.org